

Quickie® GTX

Swing-Away and Fixed Front

Supplier:

This manual must be given to the rider of this wheelchair.

Rider:

Before using this wheelchair read this entire manual and save for future reference.

Owner's Manual

Quickie® GTX

Giratoria y Frente Fijo

Distribuidor:

Este manual debe ser entregado al pasajero de esta silla de ruedas.

Pasajero:

Antes de usar esta silla de ruedas, lea este manual en su totalidad y guárdelo para futura referencia.

**Manual de
Instrucciones**

Quickie® GTX

à repose-pieds pivotants & fixes

Fournisseur :

Ce manuel doit être remis à l'utilisateur / utilisatrice de ce fauteuil roulant.

Utilisateur / utilisatrice :

Avant d'utiliser ce fauteuil roulant, lisez entièrement ce manuel et conservez-le pour le consulter ultérieurement.

Mode d'emploi

QUICKIE®

SUNRISE LISTENS

Thank you for choosing a Quickie wheelchair. We want to hear your questions or comments about this manual, the safety and reliability of your chair, and the service you receive from your Sunrise supplier. Please feel free to write or call us at the address and telephone number below:

**Sunrise Medical
Customer Service Department
7477 East Dry Creek Parkway
Longmont, Colorado 80503
(303) 218-4500 or (800) 333-4000**

Be sure to return your warranty card, and let us know if you change your address. This will allow us to keep you up to date with information about safety, new products and options to increase your use and enjoyment of this wheelchair. If you lose your warranty card, call or write and we will gladly send you a new one.

FOR ANSWERS TO YOUR QUESTIONS

Your authorized supplier knows your wheelchair best, and can answer most of your questions about chair safety, use and maintenance. For future reference, fill in the following:

Supplier: _____

Address: _____

Telephone: _____

Serial #: _____ Date/Purchased: _____

I. INTRODUCTION	2	G. Pneumatic Tires	10
II. TABLE OF CONTENTS	3	H. Offset Seating	11
III. YOUR CHAIR AND ITS PARTS	4	I. Positioning Belts.....	11
IV. NOTICE - READ BEFORE USE	5	J. Power Drive	11
V. GENERAL WARNINGS	5	K. Push Handles	11
A. Weight Limit	5	L. Quick-Release Axles	11
B. Weight Training	5	M. Rear Wheels	11
C. Getting to Know Your Chair	5	N. Rear Wheel Locks	11
D. To Reduce The Risk of an Accident	5	O. Modified Seat Systems	11
E. Safety Checklist	5	P. Upholstery Fabric	12
F. Changes & Adjustments	6	Q. Rear Suspension	12
G. Environmental Conditions	6	R. Travel Wheels	12
H. Terrain	6	IX. SET-UP AND ADJUSTMENTS	13
I. Street Use	6	A. To Mount and Remove Rear Wheels.....	13
J. Motor Vehicle Safety	6	B. Rear Wheel Axle Nut Adjustment.....	13
K. When You Need Help	6	C. Padded, Swing-Away Armrests.....	13
VI. WARNINGS: FALLS & TIP-OVERS	7	D. Height Adjustable Armrests	14
A. Center of Balance	7	E. Three-Point Height Adjustable Armrest	14
B. Dressing or Changing Clothes	7	F. Back Depth Adjustment	14
C. Wheelies	7	G. Swing-In/Out Hangers and Footrests	15
D. Obstacles	7	H. Articulating Legrest or Elevating Legrest.....	15
E. Reaching or Leaning	7	I. Footrest Height Adjustment.....	15
F. Moving Backward	8	J. Backrest	15
G. Ramps, Slopes & Sidehills	8	K. Back Angle Adjustment	16
H. Transfers	8	L. Fitting the Jay Precision Back.....	16
I. Curbs & Steps.....	8	M. Seat Sling	17
J. Stairs	8	N. Cushion Installation	17
K. Escalators	8	O. Rear Axle	17
VII. WARNINGS: FOR SAFE USE	9	P. Rear Wheel Spacing.....	19
A. Learning To Do A “Wheelie”	9	Q. Wheel Locks.....	19
B. Descending A Curb or Single Step	9	R. Casters.....	20
C. Climbing A Curb or Single Step	9	S. Anti-Tip Tubes (Optional).....	20
D. Climbing Stairs	9	T. Travel Wheels	21
E. Descending Stairs	9	U. Folding and Unfolding.....	21
F. Maintenance	9	V. Check-Out.....	21
VIII. WARNINGS: COMPONENTS & OPTIONS	10	X. TROUBLESHOOTING	22
A. Anti-Tip Tubes (Optional)	10	XI. MAINTENANCE	23
B. Armrests	10	A. Introduction.....	23
C. Caster Pin Locks.....	10	B. Maintenance Chart	23
D. Cushion & Sling Seats	10	C. Maintenance Tips.....	23
E. Fasteners	10	D. Cleaning.....	23
F. Footrests.....	10	E. Storage Tips.....	23
		XII. SUNRISE LIMITED WARRANTY	24

ESPAÑOL

25

FRANÇAIS.....

48

III. YOUR CHAIR AND ITS PARTS

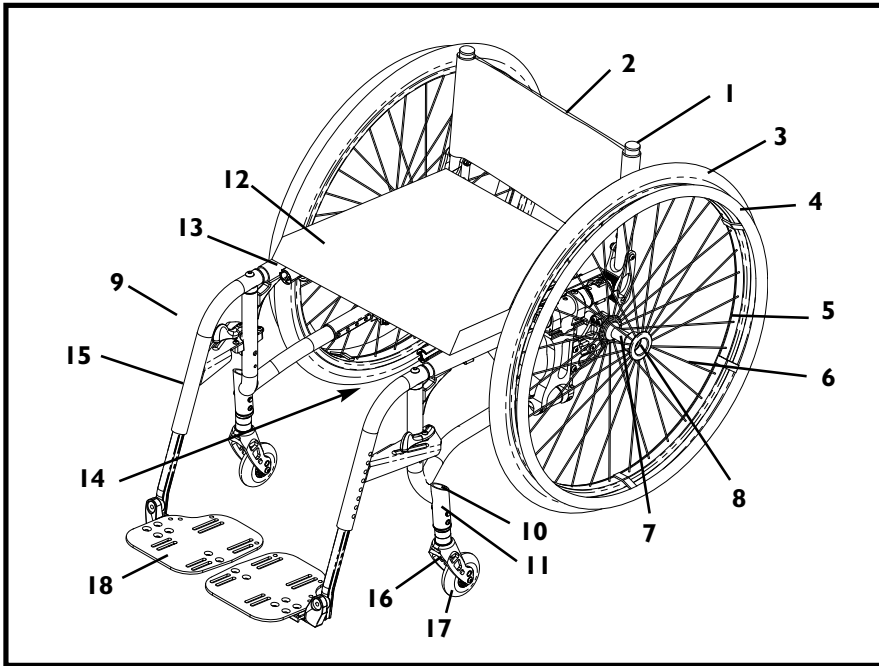

QUICKIE GTX SWING-AWAY

1. Backrest Tube
2. Backrest
3. Pneumatic Tire
4. Aluminum Handrim
5. Aluminum Wheel Rim
6. Spokes
7. Rear Wheel Hub
8. Quick-Release Axle
9. Swing-Away Latch Release
10. Caster Housing Cap
11. Caster Housing
12. Seat Cushion
13. Seat Sling
14. X-Hinge (not shown— under seat)
15. Swing-Away Legrest
16. Caster Fork
17. Caster Tire
18. Flip-Up Footrest

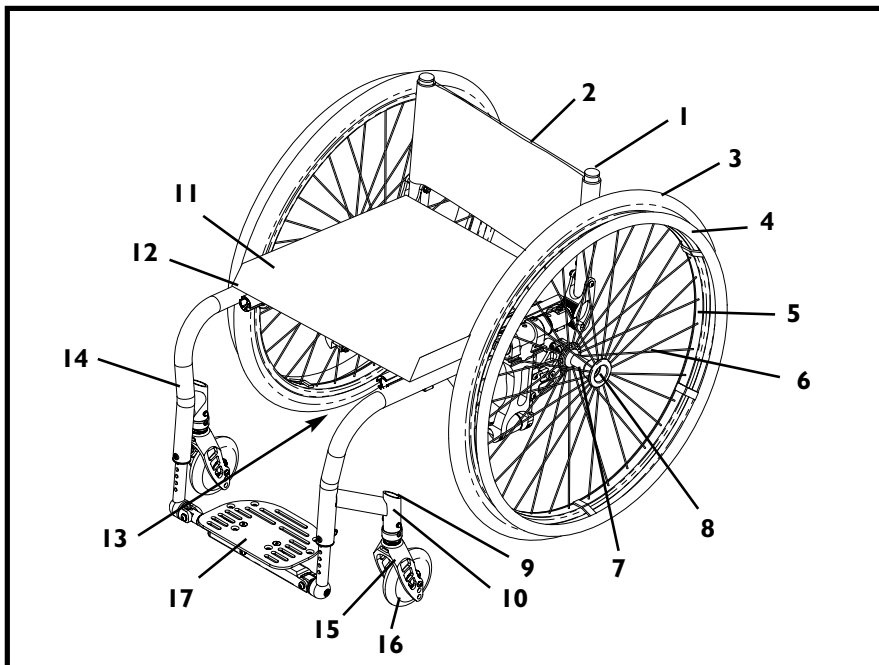

QUICKIE GTX FIXED FRONT

1. Backrest Tube
2. Backrest
3. Pneumatic Tire
4. Aluminum Handrim
5. Aluminum Wheel Rim
6. Spokes
7. Rear Wheel Hub
8. Quick-Release Axle
9. Caster Housing Cap
10. Caster Housing
11. Seat Cushion
12. Seat Sling
13. X-Hinge (not shown— under seat)
14. Fixed Legrest
15. Caster Fork
16. Caster Tire
17. Fixed Composite Footrest

A. CHOOSE THE RIGHT CHAIR & SAFETY OPTIONS

Sunrise provides a choice of many wheelchair styles to meet the needs of the wheelchair rider. However, final selection of the type of wheelchair, options and adjustments rests solely with you and your health care advisor. Choosing the best chair and set-up for your safety depends on such things as:

1. Your disability, strength, balance and coordination.
2. The types of hazards you must overcome in daily use (where you live and work, and other places you are likely to use your chair).
3. The need for options for your safety and comfort (such as anti-tip tubes, positioning belts, or special seating systems).

B. REVIEW THIS MANUAL OFTEN

Before using this chair you, and each person who may assist you, should read this entire manual and make sure to follow all instructions. Review the warnings often, until they are second nature to you.

C. WARNINGS

The word "WARNING" refers to a hazard or unsafe practice that may cause severe injury or death to you or to other persons. The "Warnings" are in four main sections, as follows:

1. V — GENERAL WARNINGS

Here you will find a safety checklist and a summary of risks you need to be aware of before you ride this chair.

2. VI — WARNINGS — FALLS & TIP-OVERS

Here you will learn how to avoid a fall or tip-over while you perform daily activities in your chair.

3. VII — WARNINGS — FOR SAFE USE

Here you will learn about practices for the safe use of your chair

4. VIII — WARNINGS — COMPONENTS & OPTIONS

Here you will learn about the components of your chair and options you can select for safety. Consult your authorized supplier and your health care advisor to help you choose the best set-up and options for safe use.

NOTE— *Where they apply, you will also find "Warnings" in other sections of this manual. Heed all warnings in this section. If you fail to do so a fall, tip-over or loss of control may occur and cause severe injury to the rider or others.*

V. GENERAL WARNINGS

A. WEIGHT LIMIT

WARNING

NEVER exceed the weight limit of 250 pounds (113.6 kg) for the Quickie GTX Swing-Away, Quickie GTX Fixed Front (or 308 pounds (140 kg) for heavy duty option), for combined weight of rider and items carried. If you do exceed the limit, damage to your chair, a fall, tip-over or loss of control may occur and cause severe injury to the rider or others. (The Heavy Duty includes: Stabilizer and Reinforced Upholstery.)

B. WEIGHT TRAINING

WARNING

NEVER use this chair for weight training if total weight (rider plus equipment) exceeds 250 pounds for Quickie GTX Swing-Away or Quickie GTX Fixed Front (or 308 pounds for heavy duty option). If you do exceed the limit, damage to your chair, a fall, tip-over or loss of control may occur and cause severe injury to the rider or others.

C. GETTING TO KNOW YOUR CHAIR

WARNING

Every wheelchair is different. Take the time to learn the feel of this chair before you begin riding. Start slowly, with easy, smooth strokes. If you are used to a different chair, you may use too much force and tip over. If you use too much force, damage to your chair, a fall, tip-over or loss of control may occur and cause severe injury to the rider or others.

D. TO REDUCE THE RISK OF AN ACCIDENT

WARNING

1. BEFORE riding, you should be trained in the safe use of this chair by your health care advisor.
2. Practice bending, reaching and transfers until you know the limit of your ability. Have someone help you until you know what can cause a fall or tip-over and how to avoid doing so.
3. Be aware that you must develop your own methods for safe use best suited to your level of function and ability.
4. NEVER try a new maneuver on your own until you are sure you can do it safely.
5. Get to know the areas where you plan to use your chair. Look for hazards and learn how to avoid them.
6. Use anti-tip tubes unless you are a skilled rider of this chair and are sure you are not at risk to tip over.

If you fail to heed these warnings damage to your chair, a fall, tip-over or loss of control may occur and cause severe injury to the rider or others.

E. SAFETY CHECKLIST

WARNING

Before Each Use Of Your Chair:

1. Make sure the chair rolls easily and that all parts work smoothly. Check for noise, vibration, or a change in ease of use. (They may indicate low tire pressure, loose fasteners, or damage to your chair).
2. Repair any problem. Your authorized supplier can help you find and correct the problem.
3. Check to see that both quick-release rear axles are locked. When locked, the axle button will "pop out" fully. If not locked, the wheel may come off and cause you to fall.

- If your chair has anti-tip tubes, lock them in place.

NOTE– See “Anti-Tip Tubes” (Section VIII) for times you should not use them.

If you fail to heed these warnings damage to your chair, a fall, tip-over or loss of control may occur and cause severe injury to the rider or others.

F. CHANGES & ADJUSTMENTS

⚠ WARNING

- If you modify or adjust this chair, it may increase the risk of a tip-over.
- Consult your authorized supplier **BEFORE** you modify or adjust your chair.
- We recommend that you use anti-tip tubes until you adapt to the change and are sure you are not at risk to tip over.
- Unauthorized modifications or use of parts not supplied or approved by Sunrise may change the chair structure. This will void the warranty and may cause a safety hazard.

If you fail to heed these warnings damage to your chair, a fall, tip-over or loss of control may occur and cause severe injury to the rider or others.

G. ENVIRONMENTAL CONDITIONS

⚠ WARNING

- Use extra care if you must ride your chair on a wet or slick surface. If you are in doubt, ask for help.
- Contact with water or excess moisture may cause your chair to rust or corrode. This could cause your chair to fail.
 - Do not use your chair in a shower, pool or other body of water. The chair tubing and parts are not water-tight and may rust or corrode from the inside.
 - Avoid excess moisture (for example, do not leave your chair in a damp bathroom while taking a shower).
 - Dry your chair as soon as you can if it gets wet, or if you use water to clean it.

If you fail to heed these warnings damage to your chair, a fall, tip-over or loss of control may occur and cause severe injury to the rider or others.

H. TERRAIN

⚠ WARNING

- Your chair is designed for use on firm, even surfaces such as concrete, asphalt and indoor floors and carpeting.
- Do not operate your chair in sand, loose soil or over rough terrain. This may damage wheels or axles or loosen fasteners of your chair.

If you fail to heed these warnings damage to your chair, a fall, tip-over or loss of control may occur and cause severe injury to the rider or others.

I. STREET USE

⚠ WARNING

In most states, wheelchairs are not legal for use on public roads. Be alert to the danger of motor vehicles on roads or in parking lots.

- At night, or when lighting is poor, use reflective tape on your chair and clothing.
- Due to your low position, it may be hard for drivers to see you. Make eye contact with drivers before you go forward. When in doubt, yield until you are sure it is safe.

If you fail to heed these warnings damage to your chair, a fall, tip-over or loss of control may occur and cause severe injury to the rider or others.

J. MOTOR VEHICLE SAFETY

Identify whether your chair has been manufactured with the Transit Option installed.

⚠ WARNING

If your chair is **NOT** equipped with the Transit Option:

- NEVER** let anyone sit in this chair while in a moving vehicle.
 - ALWAYS** move the rider to an approved vehicle seat.
 - ALWAYS** secure the rider with proper motor vehicle restraints.
- In an accident or sudden stop the rider may be thrown from the chair. Wheelchair seat belts will not prevent this, and further injury may result from the belts or straps.
- NEVER** transport this chair in the front seat of a vehicle. It may shift and interfere with the driver.
- ALWAYS** secure this chair so that it cannot roll or shift.
- Do not use any chair that has been involved in a motor vehicle accident.

If you fail to heed these warnings damage to your chair, a fall, tip-over or loss of control may occur and cause severe injury to the rider or others.

If your chair is equipped with the Transit Option: See section VII. Warnings: For Safe Use, Part G. Transit Option.

K. WHEN YOU NEED HELP

⚠ WARNING

For The Rider:

Make sure that each person who helps you reads and follows all warnings and instructions that apply.

For Attendants:

- Work with the rider’s doctor, nurse or therapist to learn safe methods best suited to your abilities and those of the rider.
- Tell the rider what you plan to do, and explain what you expect the rider to do. This will put the rider at ease and reduce the risk of an accident.
- Make sure the chair has push handles. They provide secure points for you to hold the rear of the chair to prevent a fall or tip-over. Check to make sure push handle grips will not rotate or slip off.
- To prevent injury to your back, use good posture and proper body mechanics. When you lift or support the rider or tilt the chair, bend your knees slightly and keep your back as upright and straight as you can.
- Remind the rider to lean back when you tilt the chair backward.
- When you descend a curb or single step, slowly lower the chair in one easy movement. Do not let the chair drop the last few inches to the ground. This may damage the chair or injure the rider.
- To avoid tripping, unlock and rotate anti-tip tubes up, out of the way.
- ALWAYS** lock the rear wheels and lock anti-tip tubes in place if you must leave the rider alone, even for a moment. This will reduce the risk of a tip-over or loss of control of the chair.

If you fail to heed these warnings damage to your chair, a fall, tip-over or loss of control may occur and cause severe injury to the rider or others.

A. CENTER OF BALANCE**⚠ WARNING**

The point where this chair will tip forward, back or to the side depends on its center of balance and stability. How your chair is set up, the options you select and the changes you make may affect the risk of a fall or tip-over.

1. **The Most Important Adjustment Is:**
The position of the rear wheels. The more you move the rear wheels forward, the more likely your chair will tip over backward.
2. **The Center Of Balance Is Also Affected By:**
 - a. A change in the set-up of your chair, including:
 - The distance between the rear wheels.
 - The amount of rear wheel camber.
 - The seat height and seat angle.
 - Backrest angle.
 - b. A change in your body position, posture or weight distribution.
 - c. Riding your chair on a ramp or slope.
 - d. The use of a back pack or other options and the amount of added weight.
3. **To Reduce The Risk Of An Accident:**
 - a. Consult your doctor, nurse or therapist to find out what axle and caster position is best for you.
 - b. Consult your authorized supplier **BEFORE** you modify or adjust this chair. Be aware that you may need to make other changes to correct the center of balance.
 - c. Have someone help you until you know the balance points of your chair and how to avoid a tip-over.
 - d. Use anti-tip tubes.

If you fail to heed these warnings damage to your chair, a fall, tip-over or loss of control may occur and cause severe injury to the rider or others.

B. DRESSING OR CHANGING CLOTHES**⚠ WARNING**

Your weight may shift if you dress or change clothes while seated in this chair.

- To reduce the risk of a fall or tip-over:
1. Rotate the front casters until they are as far forward as possible. This makes the chair more stable.
 2. Lock anti-tip tubes in place. (If your chair does not have anti-tip tubes, back it up against a wall and lock both rear wheels).

If you fail to heed these warnings damage to your chair, a fall, tip-over or loss of control may occur and cause severe injury to the rider or others.

C. WHEELIES**⚠ WARNING**

Doing a “wheelie” means: balancing on the rear wheels of your chair, while the front casters are in the air. It is dangerous to do a “wheelie” as a fall or tip-over may occur. However, if you do it safely, a “wheelie” can help you overcome curbs and obstacles.

1. Consult your doctor, nurse or therapist to find out if you are a good candidate to learn to do a “wheelie.”
2. Do not attempt a “wheelie” **UNLESS** you are a skilled rider of this chair, or you have help.

NOTE– See steps to learn to do a “wheelie.”

If you fail to heed these warnings damage to your chair, a fall, tip-over or loss of control may occur and cause severe injury to the rider or others.

D. OBSTACLES**⚠ WARNING**

Obstacles and road hazards (such as potholes and broken pavement) can damage your chair and may cause a fall, tip-over or loss of control.

To avoid these risks:

1. Keep a lookout for danger – scan the area well ahead of your chair as you ride.
2. Make sure the floor areas where you live and work are level and free of obstacles.
3. Remove or cover threshold strips between rooms.
4. Install a ramp at entry or exit doors. Make sure there is not a drop off at the bottom of the ramp.
5. **To Help Correct Your Center Of Balance:**
 - a. Lean your upper body **FORWARD** slightly as you go **UP** over an obstacle.
 - b. Press your upper body **BACKWARD** as you go **DOWN** from a higher to a lower level.
6. If your chair has anti-tip tubes, lock them in place before you go **UP** over an obstacle.
7. Keep both of your hands on the handrims as you go over an obstacle.
8. Never push or pull on an object (such as furniture or a doorjamb) to propel your chair.

If you fail to heed these warnings damage to your chair, a fall, tip-over or loss of control may occur and cause severe injury to the rider or others.

E. REACHING OR LEANING**⚠ WARNING**

If you reach or lean it will affect the center of balance of your chair. This may cause you to fall or tip over. When in doubt, ask for help or use a device to extend your reach.

1. **NEVER** reach or lean if you must shift your weight sideways or rise up off the seat.
2. **NEVER** reach or lean if you must move forward in your seat to do so. Always keep your buttocks in contact with the backrest.
3. **NEVER** reach with both hands (you may not be able to catch yourself to prevent a fall if the chair tips).
4. **NEVER** reach or lean to the rear unless your chair has anti-tip tubes locked in place.
5. **DO NOT** reach or lean over the top of the seat back. This may damage one or both backrest tubes and cause you to fall.
6. **If You Must Reach Or Lean:**
 - a. Do not lock the rear wheels. This creates a tip point and makes a fall or tip-over more likely.
 - b. Do not put pressure on the footrests.

NOTE– *Leaning forward puts pressure on the footrests and may cause the chair to tip if you lean too far.*

- c. Move your chair as close as you can to the object you wish to reach.
- d. Do not try to pick up an object from the floor by reaching down between your knees. You are less likely to tip if you reach to the side of your chair.
- e. Rotate the front casters until they are as far forward as possible. This makes the chair more stable.

NOTE– *To do this: Move your chair past the object you want to reach, then back up alongside it. Backing up will rotate the casters forward.*

- f. Firmly grasp a rear wheel or an armrest with one hand. This will help to prevent a fall if the chair tips.

If you fail to heed these warnings damage to your chair, a fall, tip-over or loss of control may occur and cause severe injury to the rider or others.

F. MOVING BACKWARD**⚠ WARNING**

Use extra care when you move your chair backward. Your chair is most stable when you propel yourself forward. You may lose control or tip over if one of the rear wheels hits an object and stops rolling.

1. Propel your chair slowly and smoothly.
2. If your chair has anti-tip tubes, make sure to lock them in place.
3. Stop often and check to be sure your path is clear.

If you fail to heed these warnings damage to your chair, a fall, tip-over or loss of control may occur and cause severe injury to the rider or others.

G. RAMPS, SLOPES & SIDEHILLS**⚠ WARNING**

Riding on a slope, which includes a ramp or sidehill, will change the center of balance of your chair. Your chair is less stable when it is at an angle. Anti-tip tubes may not prevent a fall or tip-over.

1. Do not use your chair on a slope steeper than 10%. (A 10% slope means: one foot in elevation for every ten feet of slope length.)
2. Always go as straight up and as straight down as you can. (Do not "cut the corner" on a slope or ramp.)
3. Do not turn or change direction on a slope.
4. Always stay in the CENTER of the ramp. Make sure ramp is wide enough that you are not at risk that a wheel may fall over the edge.
5. Do not stop on a steep slope. If you stop, you may lose control of your chair.
6. NEVER use rear wheel locks to try to slow or stop your chair. This is likely to cause your chair to veer out of control.
7. Beware Of:
 - a. Wet or slippery surfaces.
 - b. A change in grade on a slope (or a lip, bump or depression). These may cause a fall or tip-over.
 - c. A drop-off at the bottom of a slope. A drop-off as small as 3/4 inch can stop a front caster and cause the chair to tip forward.
8. To Reduce The Risk Of A Fall Or Tip-Over:
 - a. Lean or press your body UPHILL. This will help adjust for the change in the center of balance caused by the slope or sidehill.
 - b. Keep pressure on the handrims to control your speed on a down slope. If you go too fast you may lose control.
 - c. Ask for help any time you are in doubt.
9. Ramps At Home & Work– For your safety, ramps at home and work must meet all legal requirements for your area. We recommend:
 - a. Width. At least four feet wide.
 - b. Guardrails. To reduce the risk of a fall, sides of ramp must have guardrails (or raised borders at least three inches high).
 - c. Slope. Not more than a 10% grade.
 - d. Surface. Flat and even, with a thin carpet or other non-skid material. (Make sure there is no lip, bump or depression.)
 - e. Bracing. Ramp must be STURDY. You may need bracing so ramp does not "bow" when you ride on it.
 - f. Avoid A Drop Off. You may need a section at the top or bottom to smooth out the transition.

If you fail to heed these warnings damage to your chair, a fall, tip-over or loss of control may occur and cause severe injury to the rider or others.

H. TRANSFER**⚠ WARNING**

It is dangerous to transfer on your own. It requires good balance and agility. Be aware that there is a point during every transfer when the wheelchair seat is not below you. To avoid a fall:

1. Work with your health care advisor to learn safe methods.
 - a. Learn how to position your body and how to support yourself during a transfer.

- b. Have someone help you until you know how to do a safe transfer on your own.

2. Lock the rear wheels before you transfer. This keeps the rear wheels from rolling.

NOTE– This will NOT keep your chair from sliding away from you or tipping.

3. Make sure to keep pneumatic tires properly inflated. Low tire pressure may allow the rear wheel locks to slip.
4. Move your chair as close as you can to the seat you are transferring to.

If possible, use a transfer board.

5. Rotate the front casters until they are as far forward as possible.
6. If you can, remove or swing footrests out of the way.
 - a. Make sure your feet do not catch in the space between the footrests.
 - b. Avoid putting weight on the footrests as this may cause the chair to tip.
7. Make sure armrests are out of the way and do not interfere.
8. Transfer as far back onto the seat surface as you can. This will reduce the risk that the chair will tip or move away from you.

If you fail to heed these warnings damage to your chair, a fall, tip-over or loss of control may occur and cause severe injury to the rider or others.

I. CURBS & STEPS**⚠ WARNING**

1. Each person who helps you should read and follow the warnings "For Safe Use" (Section VII).
2. Do not try to climb or descend a curb or step alone UNLESS you are a skilled rider of this chair and:
 - a. You can safely do a "wheelie"; and
 - b. You are sure you have the strength and balance to do so.
3. Unlock and rotate anti-tip tubes up, out of the way, so they do not interfere.
4. Do not try to climb a high curb or step (more than 4 inches high) UNLESS you have help. Doing so may cause your chair to exceed its balance point and tip over.
5. Go straight up and straight down a curb or step. If you climb or descend at an angle, a fall or tip-over is likely.
6. Be aware that the impact of dropping down from a curb or step can damage your chair or loosen fasteners.

If you fail to heed these warnings damage to your chair, a fall, tip-over or loss of control may occur and cause severe injury to the rider or others.

J. STAIRS**⚠ WARNING**

1. NEVER use this chair on stairs UNLESS you have someone to help you. Doing so is likely to cause a fall or tip-over.
2. Persons who help you should read and follow the warnings "For Attendants" and "For Safe Use" (Section VII).

If you fail to heed these warnings damage to your chair, a fall, tip-over or loss of control may occur and cause severe injury to the rider or others.

K. ESCALATORS**⚠ WARNING**

NEVER use this chair on an escalator, even with an attendant. If you do, a fall or tip-over is likely.

If you fail to heed these warnings damage to your chair, a fall, tip-over or loss of control may occur and cause severe injury to the rider or others.

⚠ WARNING

Before you assist a rider, be sure to read the warnings “For Attendants” and follow all instructions that apply. Be aware that you will need to learn safe methods best suited to your abilities.

A. LEARNING TO DO A “WHEELIE”**⚠ WARNING**

Follow these steps to help the rider learn to do a “wheelie”:

1. Read and follow the warnings for “WHEELIES.”
2. Stand at the rear of the chair. You must be able to move with the chair to prevent a tip-over.
3. Keep your hands BENEATH the push handles, ready to catch the rider if the chair tips back.
4. When you are ready, have the rider place his or her hands on the forward part of the handrims.
5. Have the rider make a quick BACKWARD movement of the rear wheels, quickly followed by a hard FORWARD thrust. (This will tilt the chair up on the balance point of the rear wheels.)
6. Have the rider make small movements of the handrims to stay in balance.

If you fail to heed these warnings damage to your chair, a fall, tip-over or loss of control may occur and cause severe injury to the rider or others.

B. DESCENDING A CURB OR SINGLE STEP**⚠ WARNING**

Follow these steps to help a rider descend a curb or single step going BACKWARD:

1. Stay at the rear of the chair.
2. Several feet before you reach the edge of the curb or step, turn the chair around and pull it backward.
3. While looking over your shoulder, carefully step back until you are off the curb or stair and standing on the lower level.
4. Pull the chair toward you until the rear wheels reach the edge of the curb or step. Then allow the rear wheels to slowly roll down onto the lower level.
5. When the rear wheels are safely on the lower level, tilt the chair back to its balance point. This will lift the front casters off the curb or step.
6. Keep the chair in balance and take small steps backward. Turn the chair around and gently lower front casters to the ground.

If you fail to heed these warnings damage to your chair, a fall, tip-over or loss of control may occur and cause severe injury to the rider or others.

C. CLIMBING A CURB OR SINGLE STEP**⚠ WARNING**

Follow these steps to help the rider climb a curb or single step going FORWARD:

1. Stay behind the chair.
2. Face the curb and tilt the chair up on the rear wheels so that the front casters clear the curb or step.
3. Move forward, placing the front casters on the upper level as soon as you are sure they are past the edge.
4. Continue forward until the rear wheels contact the face of the curb or step. Lift and roll the rear wheels to the upper level.

If you fail to heed these warnings damage to your chair, a fall, tip-over or loss of control may occur and cause severe injury to the rider or others.

D. CLIMBING STAIRS**⚠ WARNING**

1. Use at least two attendants to move a chair and rider up stairs.
2. Move the chair and rider BACKWARD up the stairs.
3. The person at the rear is in control. He or she tilts the chair back to its balance point.
4. A second attendant at the front firmly grasps a non-detachable part of the front frame and lifts the chair up and over one stair at a time.
5. The attendants move to the next stair up. Repeat for each stair, until you reach the landing.

If you fail to heed these warnings damage to your chair, a fall, tip-over or loss of control may occur and cause severe injury to the rider or others.

E. DESCENDING STAIRS**⚠ WARNING**

1. Use at least two attendants to move a chair and rider down stairs.
2. Move the chair and rider FORWARD down the stairs.
3. The person at the rear is in control. He or she tilts the chair to the balance point of the rear wheels and rolls it to the edge of the top step.
4. A second attendant stands on the third step from the top and grasps the chair frame. He or she lowers the chair one step at a time by letting the rear wheels roll over the stair edge.
5. The attendants move to the next stair down. Repeat for each stair, until you reach the landing.

If you fail to heed these warnings damage to your chair, a fall, tip-over or loss of control may occur and cause severe injury to the rider or others.

F. MAINTENANCE**⚠ WARNING**

1. Inspect and maintain this chair strictly per Maintenance Chart in Section XII.
2. If you detect a problem, make sure to service or repair the chair before use.
3. At least once a year, have a complete inspection, safety check and service of your chair made by an authorized supplier.

If you fail to heed these warnings damage to your chair, a fall, tip-over or loss of control may occur and cause severe injury or death to the rider or others. For additional maintenance information see Section XII: Maintenance.

A. ANTI-TIP TUBES (OPTIONAL)**⚠ WARNING**

Anti-tip tubes can help keep your chair from tipping over backward in most normal conditions.

1. Sunrise Recommends Use Of Anti-Tip Tubes:
 - a. UNLESS you are a skilled rider of this chair and are sure you are not at risk to tip over.
 - b. Each time you modify or adjust your chair. The change may make it easier to tip backward. Use anti-tip tubes until you adapt to the change and are sure you are not at risk to tip over.
2. When locked in place (in the “down” position) anti-tip tubes should be BETWEEN 1 1/2 to 2 inches off the ground.
 - a. If set too HIGH, they may not prevent a tip-over.
 - b. If set too LOW, they may “hang up” on obstacles you can expect in normal use. If this occurs, you may fall or your chair may tip over.
3. Keep Anti-Tip Tubes Locked In Place UNLESS:
 - a. You have an attendant; or
 - b. You have to climb or descend a curb or overcome an obstacle and can safely do so without them. At these times, make sure anti-tip tubes are up, out of the way.

If you fail to heed these warnings damage to your chair, a fall, tip-over or loss of control may occur and cause severe injury to the rider or others.

B. ARMRESTS**⚠ WARNING**

Armrests detach and will not bear the weight of this chair.

1. NEVER lift this chair by its armrests. They may come loose or break.
2. Lift this chair only by non-detachable parts of the main frame.

If you fail to heed these warnings damage to your chair, a fall, tip-over or loss of control may occur and cause severe injury to the rider or others.

C. CASTER PIN LOCKS**⚠ WARNING**

Always use both pin locks when transferring in and out of the chair.

Caster pin locks only keep the front caster wheels from changing direction, they do not lock-out the front wheels from rotation. To prevent the wheel-chair from rolling, you must engage the rear wheel locks.

If you propel your wheelchair with the caster pin locks engaged, the chair will be prevented from turning.

If you fail to heed these warnings damage to your chair, a fall, tip-over or loss of control may occur and cause severe injury to the rider or others.

D. CUSHIONS & SLING SEATS**⚠ WARNING**

1. Quickie sling seats and standard foam cushions are not designed for the relief of pressure.
2. If you suffer from pressure sores or if you are at risk that they will occur, you may need a special seat system or a device to control your posture. Consult your doctor, nurse or therapist to find out if you need such a device for your well-being.

3. Seat slings are not intended to be used as a direct seating surface. A cushion or other seating surface should be placed on the sling before use.

If you fail to heed these warnings damage to your chair, a fall, tip-over or loss of control may occur and cause severe injury to the rider or others.

E. FASTENERS**⚠ WARNING**

Many of the screws, bolts and nuts on this chair are special high-strength fasteners. Use of improper fasteners may cause your chair to fail.

1. ONLY use fasteners provided by an authorized supplier (or ones of the same type and strength, as indicated by the markings on the heads).
2. Over- or under-tightened fasteners may fail or cause damage to chair parts.
3. If bolts or screws become loose, tighten them as soon as you can.

If you fail to heed these warnings damage to your chair, a fall, tip-over or loss of control may occur and cause severe injury to the rider or others.

F. FOOTRESTS**⚠ WARNING**

1. At the lowest point, footrests should be AT LEAST 2 1/2 INCHES off the ground. If set too LOW, they may “hang up” on obstacles you can expect to find in normal use. This may cause the chair to stop suddenly and tip forward.
2. To Avoid A Trip Or Fall When You Transfer:
 - a. Make sure your feet do not “hang up” or get caught in the space between the footrests.
 - b. Avoid putting weight on the footrests, as the chair may tip forward.
3. NEVER lift this chair by the footrests. Footrests detach and will not bear the weight of this chair. Lift this chair only by non-detachable parts of the main frame.
4. Never propel the GTX Fixed Front forward or backward without the footrest being in the lock position. If using Auto Folding footrest ensure that weight is placed onto footrest. Auto Folding footplate not to be used by double amputee.

If you fail to heed these warnings damage to your chair, a fall, tip-over or loss of control may occur and cause severe injury to the rider or others.

G. PNEUMATIC TIRES**⚠ WARNING**

Proper inflation extends the life of your tires and makes your chair easier to use.

1. Do not use this chair if any of the tires are under- or over-inflated. Check weekly for proper inflation level, as listed on the tire sidewall.
2. Low pressure in a rear tire may cause the wheel lock on that side to slip and allow the wheel to turn when you do not expect it.
3. Low pressure in any of the tires may cause the chair to veer to one side and result in a loss of control.
4. Over-inflated tires may burst.

If you fail to heed these warnings damage to your chair, a fall, tip-over or loss of control may occur and cause severe injury to the rider or others.

H. OFFSET SEATING (OPTIONAL)**⚠ WARNING**

1. A fore/aft change in the backrest position will affect the center of balance of your chair.
2. Only use this option when installing a forward offset mounted seating solution, not using the standard back sling.
3. Each time you adjust or modify the backrest plane location, the change may make it easier to tip backwards. Use anti-tips until you adapt to the change, and are sure you are not at risk to tip over.

If you fail to heed these warnings damage to your chair, a fall, tip-over or loss of control may occur and cause severe injury to the rider or others.

I. POSITIONING BELTS (OPTIONAL)**⚠ WARNING**

Use positioning belts ONLY to help support the rider's posture. Improper use of these belts may cause severe injury to or death of the rider.

1. Make sure the rider does not slide down in the wheelchair seat. If this occurs, the rider may suffer chest compression or suffocate due to pressure from the belts.
2. The belts must be snug, but must not be so tight that they interfere with breathing. You should be able to slide your open hand, flat, between the belt and the rider.
3. A pelvic wedge or a similar device can help keep the rider from sliding down in the seat. Consult with the rider's doctor, nurse or therapist to find out if the rider needs such a device.
4. Use positioning belts only with a rider who can cooperate. Make sure the rider can easily remove the belts in an emergency.
5. NEVER Use Positioning Belts:
 - a. As a patient restraint. A restraint requires a doctor's order.
 - b. On a rider who is comatose or agitated.
 - c. As a motor vehicle restraint. In an accident or sudden stop the rider may be thrown from the chair. Wheelchair seat belts will not prevent this, and further injury may result from the belts or straps.

If you fail to heed these warnings damage to your chair, a fall, tip-over or loss of control may occur and cause severe injury to the rider or others.

J. POWER DRIVE**⚠ WARNING**

Do not install a power drive (with the exception of the Quickie Xtender®) on any Quickie wheelchair.

If you do:

1. It will affect the center of balance of your chair and may cause a fall or tip-over.
2. It will alter the frame and void the warranty.

If you fail to heed these warnings damage to your chair, a fall, tip-over or loss of control may occur and cause severe injury to the rider or others.

K. PUSH HANDLES (OPTIONAL)**⚠ WARNING**

When you have an attendant, make sure that this chair has push handles.

1. Push handles provide secure points for an attendant to hold the rear of this chair, to prevent a fall or tip-over. Make sure to use push handles when you have an attendant.
2. Check to make sure push handle grips will not rotate or slip off.

If you fail to heed these warnings damage to your chair, a fall, tip-over or loss of control may occur and cause severe injury to the rider or others.

L. QUICK-RELEASE AXLES**⚠ WARNING**

1. Do not use this chair UNLESS you are sure that both quick-release rear axles are locked. An unlocked axle may come off during use and cause a fall.
2. An axle is not locked until the quick-release button pops out fully. An unlocked axle may come off during use, resulting in a fall, tip-over or loss of control and cause severe injury to the rider or others.
 - Quick-Release Axles should be inspected for function and any signs of wear or bending. Replace as necessary.
 - Routinely Inspect. Replace if worn or bent.

If you fail to heed these warnings damage to your chair, a fall, tip-over or loss of control may occur and cause severe injury to the rider or others.

M. REAR WHEELS**⚠ WARNING**

A change in set-up of the rear wheels will affect the center of balance of your chair.

1. The farther you move the rear axles FORWARD, the more likely it is that your chair will tip over backward.
2. Consult your doctor, nurse or therapist to find the best rear axle set-up for your chair. Do not change the set-up UNLESS you are sure you are not at risk to tip over.
3. Adjust the rear wheel locks after you make any change to the rear axles.
 - a. If you fail to do so, the locks may not work.
 - b. Make sure lock arms embed in tires at least 1/8 inch when locked.

If you fail to heed these warnings damage to your chair, a fall, tip-over or loss of control may occur and cause severe injury to the rider or others.

N. REAR WHEEL LOCKS**⚠ WARNING**

Rear wheel locks are NOT designed to slow or stop a moving wheelchair. Use them only to keep the rear wheels from rolling when your chair is at a complete stop.

1. NEVER use rear wheel locks to try to slow or stop your chair when it is moving. Doing so may cause you to veer out of control.
2. To keep the rear wheels from rolling, always set both rear wheel locks when you transfer to or from your chair.
3. Low pressure in a rear tire may cause the wheel lock on that side to slip and may allow the wheel to turn when you do not expect it.
4. Make sure lock arms embed in tires at least 1/8 inch when locked. If you fail to do so, the locks may not work.

If you fail to heed these warnings damage to your chair, a fall, tip-over or loss of control may occur and cause severe injury to the rider or others.

O. MODIFIED SEAT SYSTEMS**⚠ WARNING**

Use of a seat system not approved by Sunrise may alter the center of balance of this chair. This may cause the chair to tip over.

1. Do not change the seat system of your chair UNLESS you consult your authorized supplier first.
2. Use of a seat system not approved by Sunrise may affect the folding mechanism of this chair.
3. Use of a seating system not provided by Sunrise is prohibited for transit use.

If you fail to heed these warnings damage to your chair, a fall, tip-over or loss of control may occur and cause severe injury to the rider or others.

P. UPHOLSTERY FABRIC

⚠ WARNING

1. Replace worn or torn fabric of seat and seat back as soon as you can. If you fail to do so, the seat or seat back may fail.
2. Sling fabric will weaken with age and use. Look for fraying, thin spots, or stretching of fabrics especially at edges and seams.
3. "Dropping down" into your chair will weaken fabric and result in the need to inspect and replace the seat more often.
4. Be aware that laundering or excess moisture will reduce flame retardation of the fabric.

If you fail to heed these warnings damage to your chair, a fall, tip-over or loss of control may occur and cause severe injury to the rider or others.

Q. REAR SUSPENSION (OPTIONAL)

⚠ WARNING

When replacing the suspension bushings, always use genuine Quickie parts. Use of non-Quickie replacement parts voids the warranty and could cause structural failure.

If you fail to heed these warnings damage to your chair, a fall, tip-over or loss of control may occur and cause severe injury to the rider or others.

R. TRAVEL WHEELS

⚠ WARNING

- Do not exceed 250 lb total weight.
- Intermittent use only
- May decrease rearward stability.

NOTE ON TORQUE SETTINGS: A torque setting is the optimum tightening which should be made on a particular fastener. It is important to use proper torque settings where specified.

A. TO MOUNT & REMOVE REAR WHEELS 1 2

⚠ WARNING

Do not use this chair UNLESS you are sure both quick-release axles are locked. An unlocked axle may come off during use and cause a fall.

NOTE- Setting the wheelchair on a flat surface, such as a workbench or table, helps make these procedures easier.

1. To Install Wheel

- a. Depress quick-release button (A) fully. This will release tension on ball bearings at other end.
- b. Insert axle (B) through hub of rear wheel.
- c. Keep button (A) depressed as you slide axle (B) into camber plug (C).
- d. Release button to lock axle in camber plug. Adjust axle if it does not lock. See Section B.
- e. Repeat steps on other side.

2. To Remove Wheel

- a. Depress quick-release button (A) fully.
- b. Remove wheel by sliding axle (B) completely out of camber plug (C).
- c. Repeat steps on other side.

NOTE- The axle is not locked until the quick-release button pops out fully (A). Check that the axle is locked by pulling on the wheel in the direction of the axle.

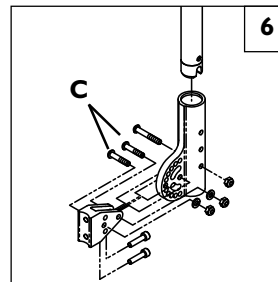
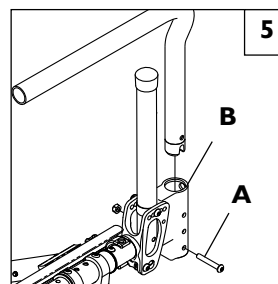
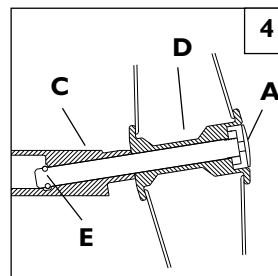
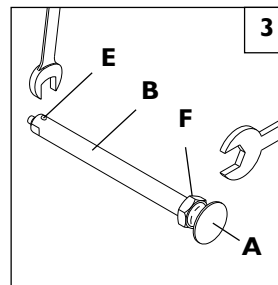
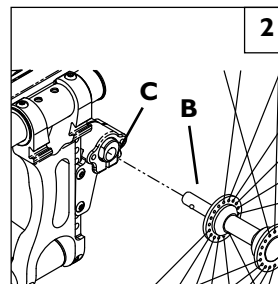
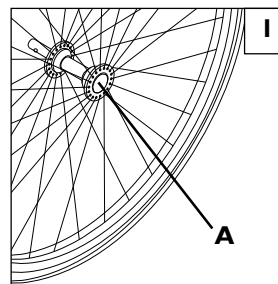

B. REAR WHEEL AXLE NUT ADJUSTMENT 3 4

The rear wheel axle (B) attaches the rear wheel (D) to the camber plug (C). When the detent balls (E) engage into the camber plug the rear wheel effectively becomes locked onto the chair. Pushing the quick-release button (A) disengages the detent balls and allows removal of the axle and wheel assembly.

To adjust the axle you will need a 3/4" wrench to turn the adjustment nut (F). You will also need a 1/2" wrench to securely hold the ball detent end of the axle to prevent it from turning.

If the wheel and axle will not lock into the camber plug then the axle requires adjustment. Turn the nut counter-clockwise approximately 1/4 revolution and try to lock the axle into the camber plug. If it doesn't lock, continue making small nut adjustments until it securely locks.

If the wheel is locked on the chair but there is excessive wheel play (the wheel hub can be pushed back and forth on the axle) then adjust the nut clockwise until there is no perceptible gap between the wheel and camber tube and the axle is securely locked onto the chair.

CAUTION- Quick-release button (A) must be flush with the edge of the wheel hub for detent balls (E) to be engaged.

C. PADDED SWING-AWAY ARMRESTS (OPTIONAL) 5

Swing-away armrests can be detached or can swing away to allow lateral transfers. They are height adjustable (1" increments) by moving bolts (A) up or down in predrilled holes on armrest bracket.

Swing-away, removable armrests are installed by sliding armrest into receiver (B) on back frame.

Swing-away, angle adjustable 6

To change the angle, remove bolts (C), reposition to needed angle. Reinsert bolt and tighten.

D. HEIGHT-ADJUSTABLE ARMRESTS (OPTIONAL) 7

1. Installation

- a. Slide the outer armpost into the receiver mounted to the wheelchair frame.
- b. The armrest will automatically lock into place.

2. Height Adjustment

- a. Rotate release lever to second stop.
- b. Slide armrest pad up or down to desired height.
- c. Return lever to locked position against armpost.
- d. Push arm pad until upper armpost locks firmly into place.

3. Removing Armrest

- a. Rotate release lever to first stop and remove the armrest.

4. Replacing Armrest

- a. Slide armrest back into receiver.
- b. Return release lever to locked position against armpost.

5. Adjusting Armrest Receiver Fit

To tighten or loosen the fit of the outer armpost in the receiver:

- a. Loosen the bolts on the sides of the receiver.
- b. With the armrest in the receiver, squeeze the receiver to achieve the desired fit.
- c. Tighten the four bolts.

6. Adjusting Inner Armpost Fit

- a. Two set screws are installed in the outer armpost.
- b. Turn the set screws in or out until the desired fit is achieved.

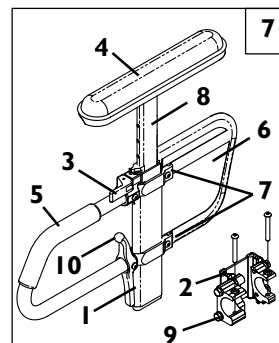

Height-Adjustable Armrest Key

1. Outer armpost
2. Standard receiver
3. Release lever
4. Armrest pad
5. Transfer bar
6. Side panel
7. Outer armpost tension adjustment set screws
8. Inner armpost
9. Receiver adjustment hardware
10. Release Lever

E. THREE-POINT HEIGHT ADJUSTABLE ARMREST 8

1. Installation

Attach lower rear pivot post (A) to back cane (B). Upper rear receiver (C) will clamp to back cane. Attached mounting hardware (D) to front of frame so that the hardware is horizontal to the locking mechanism of the armrest. Ensure all bolted hardware is firmly attached.

NOTE- 3 Point Height Adjustable Armrest is only available with tension adjustable upholstery.

NOTE- If converting to a 3 point armrest, a new backrest tube will be needed.

2. Height Adjustment

- a. Push in the locking release lever under armpad (E).
- b. Slide armrest pad up or down to desired height.
- c. Release locking lever.
- d. Slightly push the armpad up and down to ensure armpost firmly locks.

3. Swing Away Armrest

- a. Pull release handle upward (F) while lifting the armrest up and towards the rear of the wheelchair.
- b. Safely guide the armrest to its stopping point behind the rear of the wheelchair.
- c. To lock armrest back into place safely guide the armrest forward and downward until front locks back into receiver (D).

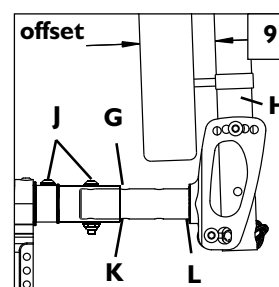
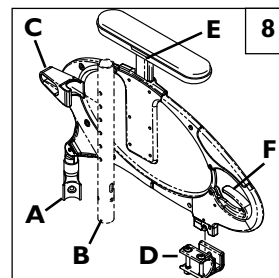

F. BACK DEPTH ADJUSTMENT (OPTIONAL) 9

NOTE- Before installing offset seating review the warning in Section VIII-O: Modified Seat Systems.

The optional offset seating plug (G) can locate the back canes (H) either 1" or 2" more rearward than the standard seating plug.

1. Before installation, determine which backrest system will be used and the offset that will be established.
2. If the offset is approximately 1" then fasten screws (J) so that the seating plug (G) is inserted in the frame allowing for 1 inch between the edge of the frame (K) and the front of the backrest spline (L) 9.
3. If the offset is approximately 2" then fasten screws (J) so that the seating plug (G) is inserted in the frame allowing for 2 inches between the edge of the frame (K) and the front of the backrest spline (L) 9.

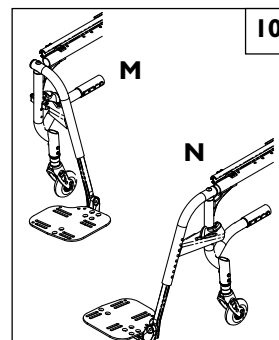

G. SWING-IN/SWING-OUT HANGERS AND FOOTRESTS (GTX SWING-AWAY) (60°, 70°, 70°V, 70° HEMI, 80° OR 90°)

1. Installation 10

- a. Place swing-in/swing-out pivot saddle into the receiver on front frame tube with the footrest facing outward from the frame. (10-M)
- b. Rotate the footrest inward until it locks into place on locking bolt. (10-N)

2. Removal

- a. To remove footrest, push release latch toward the frame.
- b. Rotate footrest outward and lift.

3. Height Adjustment 11

- a. Loosen set screws (O).
- b. Slide footrest extension up or down inside frame tube to desired height.
- c. Tighten set screws.

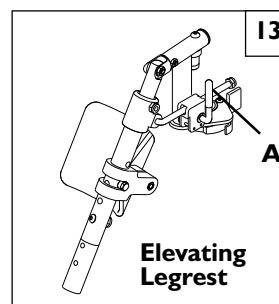
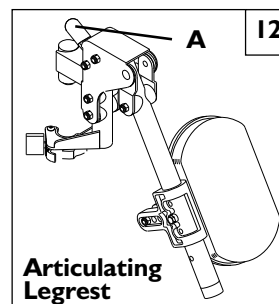
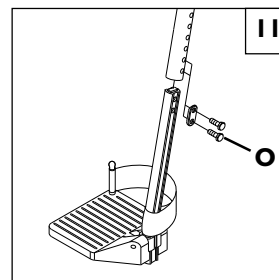

H. ARTICULATING OR ELEVATING LEGREST (GTX SWING-AWAY) 12 13

1. Installation

To install or remove articulating legrest (ALR) or elevating legrest (ELR) see instructions for swing-away hangers and footrests.

2. Adjustment

- a. To raise legrest, lift to desired position. Legrest will automatically lock in place.
- b. To lower, while seated in chair, press release lever (A) forward and lower legrest to desired position. Legrest will automatically lock in place.

I. FOOTREST HEIGHT ADJUSTMENT (GTX FIXED FRONT) 14 15

To adjust the height of your footrest, remove the screw (B) on both sides of the footrest. Slide the footrest up or down to the new desired height and tighten the two screws back into place. Use a torque setting of 120 in-lbs (13.6 Nm). It is recommended that you maintain a minimum of 2.0 inches (5 cm) between the lowest point on the footrest and the floor. Additionally, both sides of the footplate should be of equal height. This will provide adequate clearance for uneven surfaces and prevent damage to your footrest.

To adjust angle of footrest, loosen screw (C) 15. Change angle of footplate to desired position. Tighten screw (C) on both sides of footrest. Use a torque setting of 120 in-lbs (13.6 Nm).

NOTE- Footrest must be in locked position before riding in wheelchair.

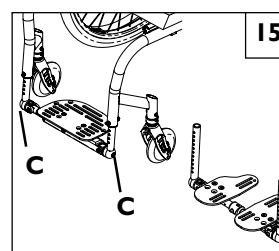
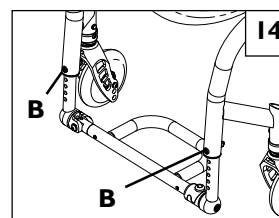

J. BACKREST 16

1. Height Adjustment

- a. Remove the backrest upholstery from the frame.
- b. You will see the backrest tube which telescopes into the frame and is secured by a screw on the side of the frame.
- c. There are holes 1 inch apart that you may choose from to set the back height.
- d. Remove the two backrest bolts from the rear frame tubes.
- e. After selecting the proper height, insert bolt through frame and backrest tube.
- f. Slide the backrest upholstery back over both backrest tubes.

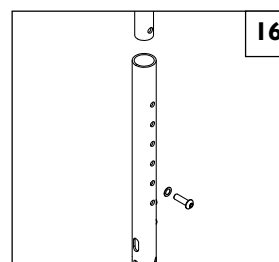

K. BACK ANGLE ADJUSTMENT 17 18

Adjusting the Back Angle

1. Using a 4mm Allen Key and 10mm wrench on opposite side completely remove the pivot screw (A) that attaches the back tube (C) to angle adjustable backrest bracket (B).
2. For folding back, loosen but don't remove cam stop (D) using a 4mm Allen Key and wrench. For non folding back, loosen but don't remove 6mm socket screw (E) and loosen but don't remove both lower 6mm button head screws (F).
3. Determine new angle by aligning the upper hole in the backrest tube (C) with the different holes in the backrest bracket (B).
4. Once proper hole is determined, while aligning hole in one end of the pivot washer with proper hole, insert pivot screw (A) through proper hole in outside wall of backrest bracket (B) and through the hole in pivot washer. Continue to feed screw through both walls of backrest tube (C). Wrap pivot washer around front of backrest tube and align remaining hole in pivot washer with proper hole on the inner wall of backrest bracket (B).
5. Once in place using a 4mm Allen Key and 10mm wrench tighten the pivot screw (A) back into place.

NOTE- For folding back, do not over tighten. Backrest must be allowed to fold easily.

6. Repeat procedure to the other side of the wheelchair.
7. Adjust and tighten cam stops for both sides of the wheelchair (D), see steps below for folding back. For non folding back tighten 6mm socket screw (E) and tighten 6mm button head screws (F) back into place.

CAUTION – When changing the back angle of the wheelchair both the left and right angle adjustable back bracket must be in the same hole position (see steps 3 & 4) before the wheelchair is to be used.

Adjusting the Cam Stop (Folding Back Option Only)

1. Once the proper back angle is set tighten the cam stop screw (D) back into place
2. Using a 10mm open-ended wrench on the inner hex drive of the cam stop, rotate the cam stop to eliminate excessive play in the back tube. Verify that backrest latches into place. If backrest will not latch, adjust cam away from tube until back tube latches freely, while still minimizing play in the backrest.
3. Check that the cam stop screw is tightened into place. (D)

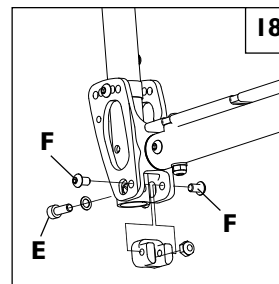
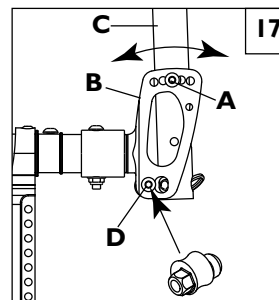

L. FITTING THE JAY® PRECISION BACK

The Jay Precision Back is a tension adjustable back that includes lateral support hardware. It is designed to follow the contour of the back of the end user and provide beneficial lateral trunk control.

1. Contour Adjustment 19

- a. To modify the contour of the Jay Precision Back: Pull the tensioning straps (A) inward to increase the tension and lift the tab of the tension lock buckle to release it.
- b. To adjust the Jay Precision Back to conform with the user's anatomy, release tension on all straps then adjust them proceeding from the base of the back upholstery moving up.
- c. These adjustments should be done with the user sitting in the chair.

2. Lateral Supports Location Setting 20

- a. Remove the lateral covers (B). Leave the lateral support foam pads on.
- b. To move the lateral supports up or down loosen the screws (C) and slide them vertically until desired location is obtained, tighten the screws to secure the lateral supports.
- c. Should more adjustment be required, two more openings are available on the back cane envelopes to allow for height adjustment of the hardware itself. To relocate the hardware loosen the screws (D) of the clamp until it can be taken off the cane. Move the clamp and hardware up or down as needed and tighten the screws firmly.
- d. The lateral supports have 2 inches of adjustment range towards the inside from the external plane of the back canes. To adjust, loosen the screws of the clamp (D), set the adjustment and tighten them back down.

NOTE- If adjustment pushes too far inward it will prevent the chair from folding completely.

- e. If adjusted too low, the lateral supports may interfere with the cross brace when folding the chair.
- f. These adjustments may be done with the user sitting in the chair.

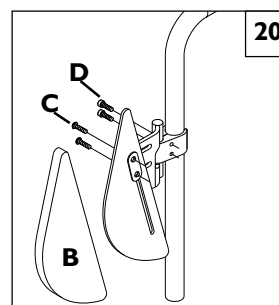
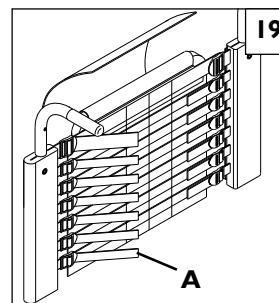

M. SEAT SLING

The seat sling can be adjusted through the use of hook and loop material beneath the seat. Seat sling also includes a folding strap on the seat to assist in folding the chair. **21**

NOTE- The seat sling folding strap is not intended as a carrying strap.

I. Adjustment **21**

- Remove seat rail end caps at the front of the chair (A).
- Slide the seat sling and plastic retaining rods from the channels in the seat rails.
- Readjust hook and loop material to obtain the desired tension in the seat sling.
- Reinsert the seat sling and plastic retaining rods into the channels in the seat rails.
- Replace the end caps.

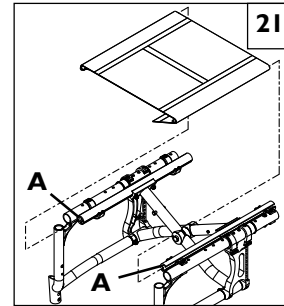

N. CUSHION INSTALLATION

- Place cushion on seat sling with hook material side down. The beveled edge of the cushion should be in front.
- Press firmly into place.

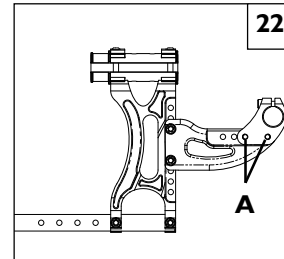

O. REAR AXLE

I. Center of Gravity Adjustment

⚠ WARNING

The more you move your rear wheels forward, the more likely your chair will tip over backwards. Always make adjustments in small increments, and check the stability of your chair with a spotter to prevent a tip-over. We recommend that you use anti-tip tubes until you adapt to the change and are sure you are not at risk to tip over. Refer to additional Warnings in Section VI “Falls and Tip Over”.

NOTE- Changes to the center of gravity may affect the rear seat height, toe-in/toe-out of the rear wheels and the squareness of the casters. If you change your center of gravity position, re-adjust all of these settings if necessary.

NOTE- Adjusting your chair’s center of gravity will require re-adjusting the location of the wheel locks (if provided). See Section “Q” for instructions on adjusting the wheel locks.

The GTX Swing Away and GTX Fixed Front has two methods of adjusting Center of Gravity (CG).

2. Primary Center of Gravity Adjustment

a. GTX Swing Away & Fixed Front **22** **23**

Place the entire wheelchair on a flat horizontal table or ground surface. Remove both rear wheels from wheelchair. Remove the four screws, washers and nuts (A) (2 per side). Thus allowing the axle sleeve clamp to be repositioned in desired location. Axle sleeve clamp can also be reversed to achieve greater range of adjustment **23**. Note, if reversing the axle sleeve clamp switch the left side clamp with the right side to eliminate the need to remove and flip axle sleeves. Reinsert four screws (A) (2 per side), washers and nuts to secure sleeve clamp. Tighten screws to 144in-lbs. (16.3Nm)

b. GTX Swing Away and Fixed Front using Short Axle **24**

There is no primary Center of Gravity adjustment with the short axle. See Section 3 for secondary adjustment.

3. Secondary Center of Gravity Adjustment

a. GTX Fixed Front **25**

Place the entire wheelchair on a flat horizontal table or ground surface. Unlatch footplate from locked position (Note, not necessary for Auto Folding footrest option). Remove both rear wheels from wheelchair. Remove four screw screws (A) atop the axle plate (2 per side) and reposition into desired location by sliding along frame. Securely tighten all four screws (A) (2 per side). Tighten screws to 88in-lbs. (10Nm). Ensure that axle plates are positioned symmetrically on frame.

b. GTX Swing Away **26**

Place the entire wheelchair on a flat horizontal table or ground surface. Remove both rear wheels from wheelchair. Remove four screw screws (A) atop the axle plate (2 per side) and two lower frame screws (B) (1 per side). Reposition into desired location by sliding along top frame and telescoping in our out of the lower frame. On lower frame adjust plastic sleeve to cover telescoping tube. Securely tighten all four screws (A) (2 per side) atop the axle plate and two lower frame screws (B) (1 per side). Tighten screws to 88in-lbs. (10Nm). Ensure that the axle plates are positioned symmetrically on frame.

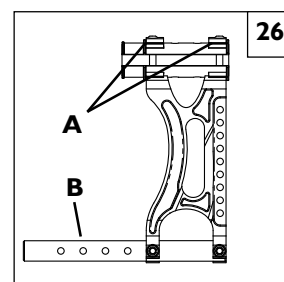
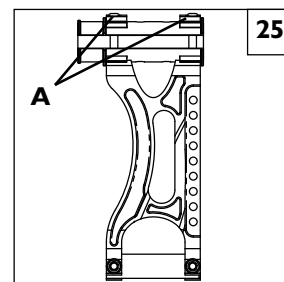
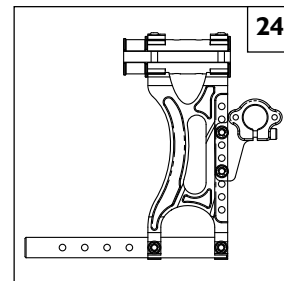
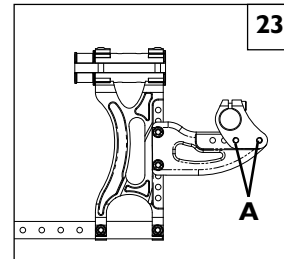

c. Reposition Seat Sling Tube- GTX Swing Away and Fixed Front 27

After making Secondary Center of Gravity adjustment the seat sling tube will need to be repositioned. Loosen the four nuts (A) (2 per side) that hold the seat sling tube to the cross brace assembly. Slide the seat sling tube either fore or aft to make the seat sling tube even with the rear frame tube. Tighten the four nuts (A) (2 per side) that hold the seat sling tube to the cross brace assembly, 88in-lbs. (10Nm). Ensure front seat sling tube position screw (B) lines up with slot in saddle. Check both side of seat sling for proper fit, readjust if necessary.

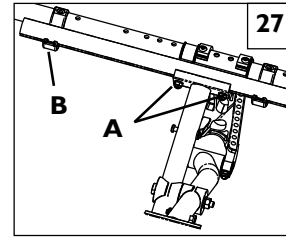

4. Wheel Camber 28

Wheel camber, shown as angular relationship (H), provides greater side-to-side stability due to the increased width and angle of the wheelbase. It also allows for quicker turning and greater access to the top of the handrims.

Wheel camber is determined by pairs of interchangeable camber plugs which are available from your authorized supplier in 0°, 2°, and 4° angles.

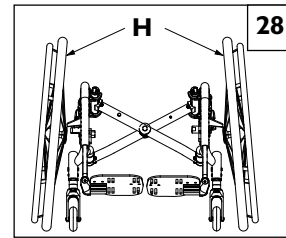

5. Setting Toe-in Toe-out to Zero 29 30 31 32

NOTE- A wheelchair equipped with 0° camber plugs cannot have a toe-in toe-out condition. This adjustment is only required when using 2° and 4° camber plugs.

Toe refers to how well the rear wheels of the chair are aligned relative to the ground 29. It affects how well the chair will roll. Drag or rolling resistance is optimally minimized when the wheel toe is set to zero.

Setting the Toe to Zero 30 31 32

Safely place the entire wheelchair on a flat horizontal table or ground surface. Starting on one side, remove rear wheel, and loosen the 2 screws (A) that secure the camber tube clamp. Locate the flat surfaces on the front and rear of the camber plugs (D). Place an object that is known to have an accurate 90° corner (such as a carpenter's square, drafting triangle, etc.) down on the flat horizontal surface and up against the flat of the camber plug. Rotate the camber tube and plug assembly until the flat surface of the camber plug is parallel to the vertical edge of the measuring tool.

Once square, tighten screws (A), and place rear wheel securely back in place. Repeat process for opposite side.

Before tightening the screws (A), make certain that the camber tube is centered left-to-right relative to the wheelchair frame. There should be an equal gap on both sides of the wheelchair (see section P: Rear Wheel Spacing).

Tighten the fasteners to 144 in-lbs. (16.3 Nm).

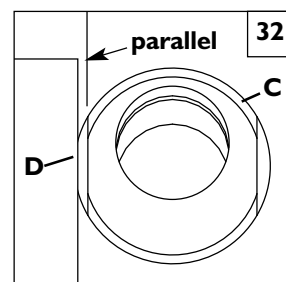
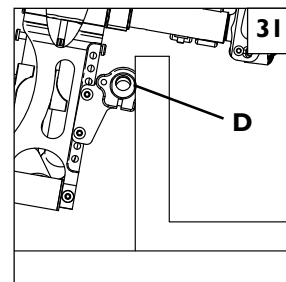
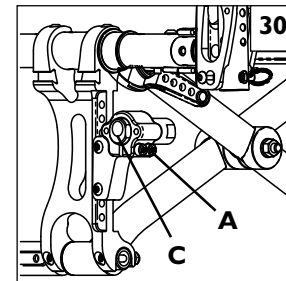
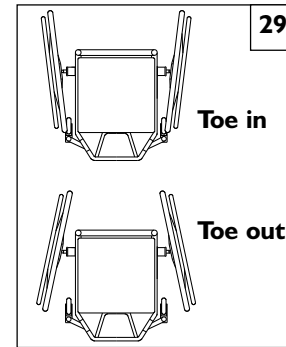

P. REAR WHEEL SPACING 33 34

Rear wheel spacing is measured as the gap between the top of the rear wheels and the backcanes, and is shown as dimension X 33. Available factory range: .75" to 1.75". The widest setting is typically required to provide adequate tire clearance when using the height adjustable armrest option.

NOTE— When setting the rear wheel spacing only make adjustments to one side of the chair at a time. Loosening both sides will undo the toe setting.

To adjust the rear wheel spacing, the camber inserts (E) telescope in and out of the axle bracket (F). On the left side of the chair, loosen screws (G). Slide the camber insert in or out to establish the required wheel spacing. Tighten screw to 144 in-lbs. (16.3 Nm). Repeat on the right side of the chair, matching the wheel spacing set on the left side. Ensure toe in/out maintains proper setting (see Section O-4: Setting Toe-in Toe-out to Zero).

Rear Wheel Axle Adjustment

Tight axle sleeves should be maintained for proper performance of the wheelchair.

- a. To adjust the axle you will need a 3/4" wrench to turn the outside axle nuts.
- b. You will also need a 1/2" wrench to lodge the ball bearings, on the opposite end of the axle, and prevent the axle from turning.
- c. Turn the outside axle nut counterclockwise to tighten.
- d. There should only be zero to ten thousandths of an inch (.010") of play (see Section B: Rear Wheel Axle Nut Adjustment).

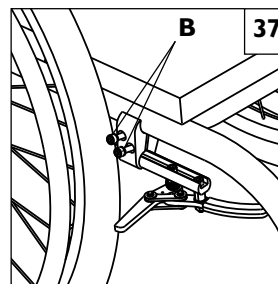
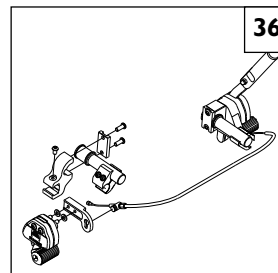
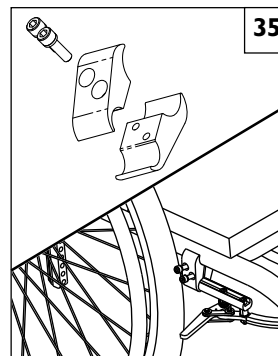
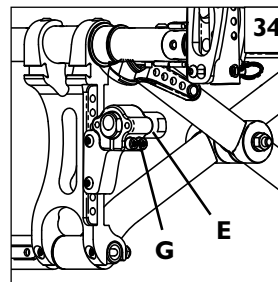
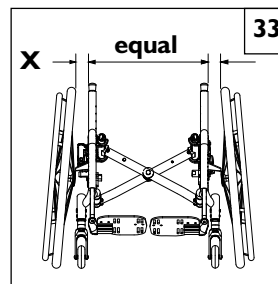

Q. WHEEL LOCKS

Quickie GTX Swing-Away and Quickie GTX Fixed Front wheelchairs are shipped with one of five types of wheel locks. Wheel locks are installed at the factory unless you have requested otherwise.

Use a torque setting of 100 in.-lbs. when setting up wheel locks.

1. High-Mount Push-to-Lock or Pull-to-Lock 35, **One-Hand/Unilateral** 36

Wheel Locks Adjustment

- a. Using a 5mm Allen wrench, turn one of the screws in the clamp counterclockwise one-quarter turn.
- b. Repeat the same process with the second of the two screws.
- c. Alternately loosen the screws (two turns each) until both screws are removed.
- d. Slide clamp toward the rear wheel until the wheel lock is embedded into the tire to prevent wheel movement, when in the locked position.
- e. Tighten screws to 144 in-lbs. (16.3 Nm).

2. Ergo Scissor Wheel Locks 37 **or Short Throw Scissor Wheel Locks**

Loosen the screws (B) on the top of each clamp using a 5mm Allen wrench. Slide assembly toward rear wheel until clamp embeds into tire to prevent wheel movement when in locked position. Adjust angle position. Tighten screws to 144 in-lbs. (16.3 Nm).

NOTE— Clamp and wheel lock may need to be rotated to clear frame tubing.

R. CASTERS

NOTE— Setting the wheelchair on a very flat table or a workbench makes this setting more accurate.

NOTE ON TORQUE SETTING— A torque setting is the optimum tightening which should be made on a particular fastener. Use proper torque settings when specified.

1. Adjusting Caster Angle 38 39

Checking for Caster Squareness:

Your Quickie wheelchair leaves the factory with the casters adjusted square. Any time you change your wheelchair rear axle height, rear tire size, center of gravity position or camber tube, you should check that the casters are still square. A caster that is not square will result in the caster lifting off the floor as it rotates around the stem bolt 38 and may also lift the front of the wheelchair up and down. Check for squareness by placing your wheelchair on a flat, horizontal surface. Rotate both forks so that the casters are towards the rear of the wheelchair. Place a square or pocket level against the flat surface on the rear of the fork and note whether this surface is vertical (square) 39. If this surface is more than 1 degree away from vertical, your casters require re-squaring.

2. Re-squaring Your Casters 40 41

Gently pry cap (A) off of both caster tubes. Locate the set screw (B) inside the right caster tube and loosen using an 8mm Allen wrench. Do not remove the set screw. Simply loosen it enough to allow the teeth on the upper and lower splines (C) to clear one another. With the stem bolt loosened, the caster fork should pivot freely. Place the wheelchair on the floor so that the two rear wheels and left caster contact the floor. Place some weight in the seat towards the rear to help stabilize the chair. Place a square or pocket level against the flat surface of the fork and pivot the fork until it is vertical (square) 39. With the fork vertical, engage the teeth of the two splines to the closest mating position. Make certain that the teeth are properly engaged and not crossed. Shine a bright light behind the mating spline teeth and check for proper teeth engagement. Tighten the set screw (B) to secure the spline mating position. The set screw should be tightened to 192 in.-lbs. (21.7 Nm) to ensure that it does not loosen during use.

Record the teeth engagement position of the splines on the right fork, and adjust the left fork in a similar fashion to the same position. Reassemble both casters, and re-check that they are square. Replace caps.

S. ANTI-TIP TUBES (OPTIONAL)

Quickie recommends anti-tip tubes for all wheelchairs.

Use a torque setting of 100 in.-lbs. when setting up the anti-tip tubes.

1. Inserting Anti-Tip Tubes Into Receiver 42 43

- a. Press the rear anti-tip release pin (A) on the anti-tip tube so that both release pins are drawn inside.
- b. Insert into the anti-tip tube receiver.
- c. Turn the anti-tip tube down until release pin is positioned through the receiver mounting hole (B).
- d. Insert second anti-tip tube the same way.

NOTE— If using standard or amputee axle plate, an adapter plate will be necessary to mount anti-tip receiver to axle plate 43.

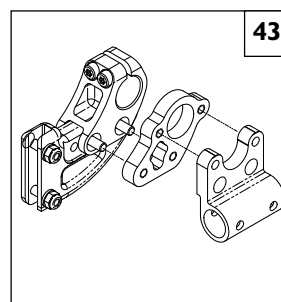
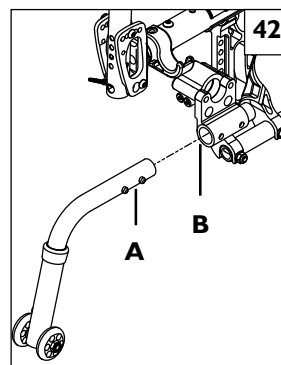
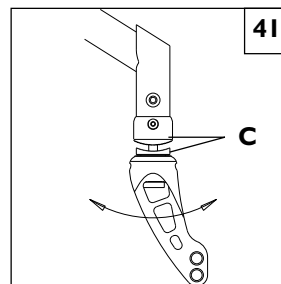
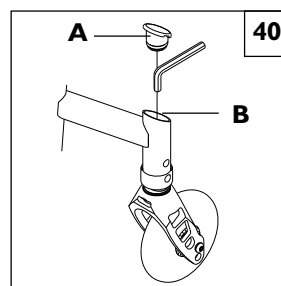
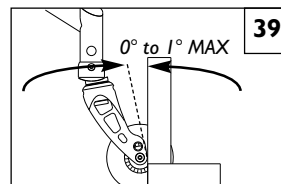
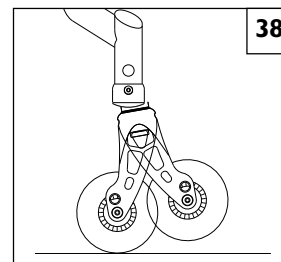

2. Adjusting Anti-Tip Tube Wheel 44

The anti-tip tube wheels may have to be raised or lowered to achieve proper clearance of 1 1/2" to 2".

- a. Press the anti-tip wheel release pin (D) so that the release pin is drawn inside.
- b. Raise or lower to one of the three predrilled holes.
- c. Release pin.
- d. Adjust the second anti-tip tube wheel the same way.
Both wheels should be at exactly the same height.

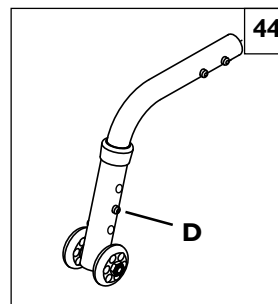

3. Turning Anti-Tip Tubes Up 45

Turn anti-tip tubes up when being pushed by attendant, overcoming obstacles or climbing curbs.

- a. Press the rear anti-tip tube release pin (A).
- b. Hold pin in and turn anti-tip tube up.
- c. Release pin.
- d. Repeat with second anti-tip tube.
- e. Remember to return anti-tip tubes to down position after completing maneuver.

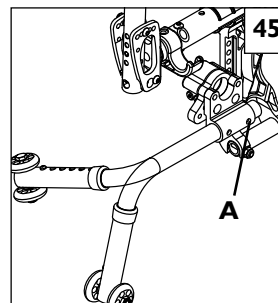

T. TRAVEL WHEELS 46 47

1. Removing Travel Wheels from Receivers

- a. Remove the quick-release pin (A).
- b. Remove the travel wheel (B) from the receiver (C).
- c. Repeat for other side.

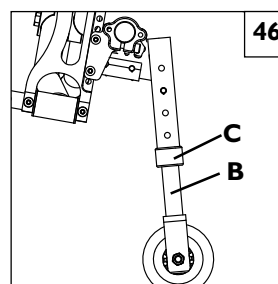

2. Inserting Travel Wheels into Receivers

- a. Insert the travel wheel (B) into the receiver (C).
- b. Align holes at position for corresponding rear wheel size.
- c. Insert the quick-release pin (A) fully.
- d. Repeat for other side. Both travel wheels must be set at the same height.

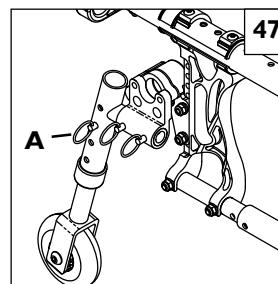

U. FOLDING AND UNFOLDING

1. Folding Chair

- a. Remove quick-release wheels (optional).
 - Depress quick-release button on the axle.
 - Remove wheel by sliding out quick-release axle from axle bracket.
 - Repeat with other wheel.
- b. For the GTX Swing Away model, flip up the footrest to a vertical position before folding the wheelchair. For the GTX Fix Front model, release latch button so the footrest can be placed in the vertical position before folding the wheelchair. Note, for GTX Fixed Front, the Auto-Folding footrest will fold automatically when lifting the seat sling (step C).
- c. Grasp the seat sling (in the center) and lift sharply until the wheelchair is folded.

2. Unfolding Chair

- a. Replace quick-release wheel (optional) by depressing the quick-release button on the axle.
- b. Slide it into the axle sleeve until it locks.
- c. Repeat with other wheel.
- d. Tilt the wheelchair toward you far enough to take the weight off the opposite wheel.
- e. Push down on the seat rail (closest to you) until the wheelchair is completely opened.
- f. Make sure seat rail tubes are resting in the seat rail saddles.

NOTE- Ensure that footrest is locked prior to use.

V. CHECK-OUT

After the wheelchair is assembled and adjusted, it should roll smoothly and easily. All accessories should also perform smoothly. If you have any problems, follow these procedures:

1. Review the set-up and check-out sections and operating guide to make sure chair was properly prepared.
2. Review troubleshooting guide.
3. If your problem persists, contact your authorized supplier. If you still have a problem after contacting your authorized supplier, contact Sunrise customer service. See the introduction page for details on how to contact your authorized supplier or Sunrise customer service.

You will need to adjust your chair from time to time for best performance (especially if you alter the original settings). This chart gives you a first solution, then a second and a third if needed. You may need to look farther to find the best solution for a specific problem.

NOTE– To keep track of your progress, make only ONE change at a time.

Symptom							Solution
	Left turn in chair	Right Turn in chair	Looseness in chair	Sluggish turning	Squeaks and rattles	Caster flutter	
	✓	✓	✓	✓			Make sure tire pressure is correct and equal in both rear tires and front caster tires, if pneumatic.
			✓	✓	✓	✓	Make sure all nuts and bolts are snug.
			✓		✓		Make sure all spokes and nipples are tight on radial spoke wheels.
					✓		Use Tri-Flow Lubricant (Teflon®-based) between all modular frame connections and parts.
	✓	✓		✓		✓	Check for proper caster plate adjustment. See instructions for caster plate adjustment.

A. INTRODUCTION

1. Proper maintenance will improve performance and extend the useful life of your chair.
2. Clean your chair regularly. This will help you find loose or worn parts and make your chair easier to use.
3. Repair or replace loose, worn, bent or damaged parts **before using this chair**.
4. To protect your investment, have all major maintenance and repair work done by your authorized supplier.

⚠ WARNING

If you fail to heed these warnings your chair may fail and cause severe injury to the rider or others.

1. **Inspect and maintain this chair strictly per maintenance chart.**
2. **If you detect a problem, make sure to service or repair the chair before use.**
3. **At least once a year, have a complete inspection, safety check and service of your chair made by an authorized supplier.**

B. MAINTENANCE CHART

Weekly	3 Months	6 Months	Annually	Check...
✓				Tire inflation level
✓				Wheel locks
	✓			All fasteners for wear and tightness
		✓		Armrests
		✓		Axle and axle sleeves
	✓			Quick-release axles
	✓			Wheels, tires and spokes
	✓			Casters
	✓			Anti-tip tubes
		✓		Frame and crossbrace
	✓			Upholstery
			✓	Service by Authorized Supplier

C. MAINTENANCE TIPS

1. Axles & Axle Sleeves:

Check axles and axle sleeves every six months to make sure they are tight. Loose sleeves will damage the axle plate and will affect performance.

2. Tire Air Pressure:

Check air pressure in pneumatic tires at least ONCE A WEEK. The wheel locks will not grip properly if you fail to maintain the air pressure shown on tire sidewall.

D. CLEANING

1. Paint Finish

- a. Clean the painted surfaces with mild soap at least once a month.
- b. Protect the paint with a coat of non-abrasive auto wax every three months.

2. Axles and Moving Parts

- a. Clean around axles and moving parts WEEKLY with a slightly damp (not wet) cloth.
- b. Wipe off or blow away any fluff, dust or dirt on axles or moving parts.

NOTE– You do not need to grease or oil the chair.

3. Upholstery

- a. Hand-wash (machine washing may damage fabric).
- b. Drip-dry only. DO NOT machine dry as heat will damage fabric.

E. STORAGE TIPS

1. Store your chair in a clean, dry area. If you fail to do so, parts may rust or corrode.
2. Before using your chair, make sure it is in proper working order. Inspect and service all items on the “Maintenance Chart”.
3. If stored for more than three months, have your chair inspected by an authorized supplier before use.

A. FOR LIFETIME

Sunrise warrants the frame and quick-release axles of this wheelchair against defects in materials and workmanship for the life of the original purchaser.

The expected life of this frame is five years.

B. FOR ONE (1) YEAR

We warrant all Sunrise-made parts and components of this wheelchair against defects in materials and workmanship for one year from the date of first consumer purchase.

C. LIMITATIONS

1. We do not warrant:
 - Tires and tubes, upholstery, armrests and push-handle grips.
 - Damage from neglect, misuse or from improper installation or repair.
 - Damage from exceeding weight limit of 250 pounds (or 308 pounds for heavy duty option).
2. This warranty is VOID if the original chair serial number tag is removed or altered.
3. This warranty applies in the USA only. Check with your supplier to find out if international warranties apply.

D. WHAT WE WILL DO

Our sole liability is to repair or replace covered parts. This is the exclusive remedy for consequential damages.

E. WHAT YOU MUST DO

1. Obtain from us, while this warranty is in effect, prior approval for return or repair of covered parts.
2. Return the wheelchair or part(s), freight pre-paid, to Sunrise Mobility Products Division at: 2842 Business Park Avenue, Fresno, CA 93727-1328.
3. Pay the cost of labor to repair, remove or install parts.

F. NOTICE TO CONSUMER

1. If allowed by law, this warranty is in place of any other warranty (written or oral, expressed or implied, including a warranty of merchantability, or fitness for a particular purpose).
2. This warranty gives you certain legal rights. You may also have other rights that vary from state to state.

Record your serial number here for future reference:
